

REV.	DESCRIPTION	NAME	DATE
A	NEWS ISSUE	Rain.Yi	2023/04/13

NOTES:

1.MATERIAL:

- 1-1. INSERTMOLDING: LCP, COLOR:BACK,UL94-V0.
- 1-2. CONTACT: C2680(T=0.20mm) ;
GOLD FLASH ON CONTACT AREA,
100u" Min. Tin PLATED ON SOLDER TAILS.
50u" Min. NICKEL PLATED OVERALL.
- 1-3. SHELL: SPCC,(T=0.40mm) ;
100u" Min. NICKEL PLATED OVERALL.
120u" Min. COPPER BOTTOM PLATED OVERALL.

2.ELECTRICAL CHARACTERISTICS:

- 2-1. CURRENT RATING: 0.5A
- 2-2. CONTACT RESISTANCE: 30mΩ MAX.
- 2-3. INSULATION RESISTANCE: 100MΩ MIN.
- 2-4. DIELECTRIC WITHSTAND VOLTAGE: AC 500V/MINUTE.
- 2-5. OPERATING TEMPERATURE RANGE: -25°C~+85°C

3.MECHANICAL CHARACTERISTICS:

- 3-1. INSERTION FORCE: 4.5Kgf MAX.
- 3-2. EXTRACTION FORCE: 1.0Kgf MIN.,4.0Kgf MAX.

4.DURABILITY: 5000 CYCLES.

5.SALT FOG TEST:24H.

6.PART NO. HAR01-1194K-00BR

K: GOLD FLASH PLATING ON CONTACT AREA,
Matte Tin PLATING ON SOLDER AREA

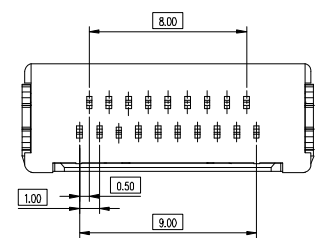
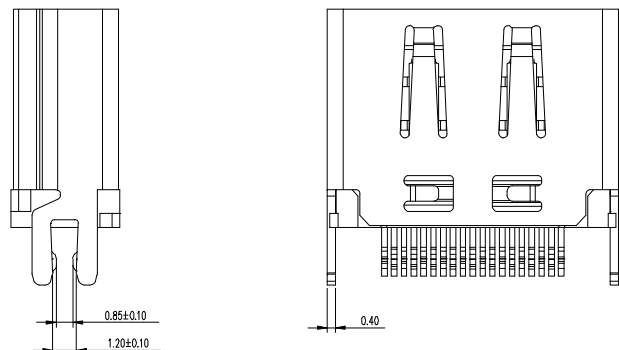
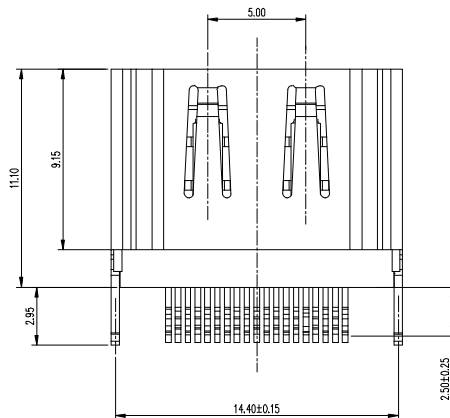
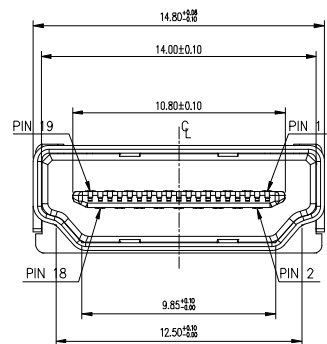
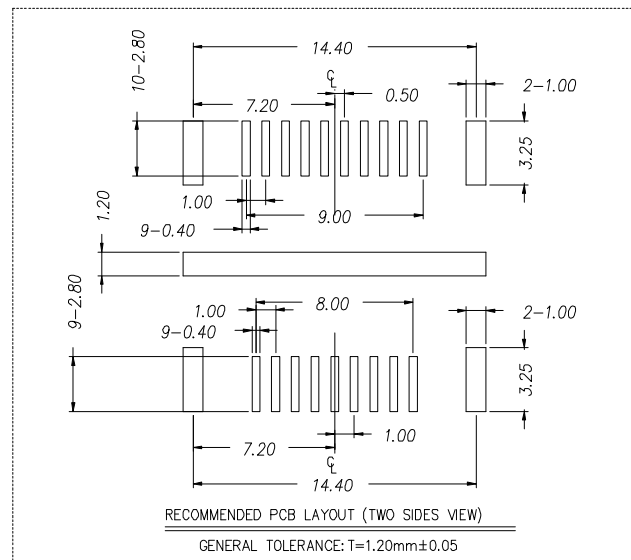
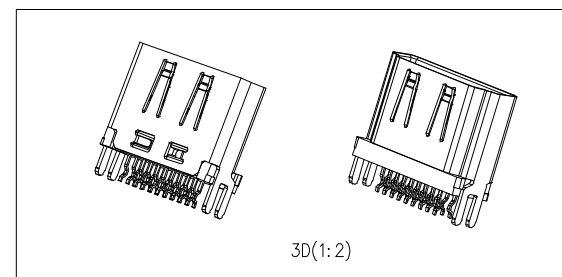

PIN	Signal Assignment	PIN	Signal Assignment
1	TMDS Data2+	2	TMDS Data2 Shield
3	TMDS Data2-	4	TMDS Data1+
5	TMDS Data1 Shield	6	TMDS Data1-
7	TMDS Data0+	8	TMDS Data0 Shield
9	TMDS Data0-	10	TMDS Clock+
11	TMDS Clock Shield	12	TMDS Clock-
13	CEC	14	Utility
15	SCL	16	SDA
17	DDC/CEC Ground	18	+5V Power
19	Hot Plug Detect		

TOLERANCE UNSPECIFIED	
.0	±0.25
.00	±0.10
.000	±0.10
X.*	±1.00*

ASSEMBLY DRAWING

DRAWN	Rain.Yi
DATE	2023/04/13
CHECKED	Rain.Yi
DATE	2023/04/13
APPROVED	LCY
DATE	2023/04/13

<p>东莞市韩晶电子有限公司 Dongguan Hanjing Electronics Co., LTD</p>		TITLE: HDMI 夹板式母座 成品图	
		SIZE: A4	UNIT:mm.
SCALE: 1:1	PROJECTION		
DWG PATH	REV.: A		PATH 1/2

REV.	DESCRIPTION	NAME	DATE
A	NEWS ISSUE	Rain.Yi	2023/04/13

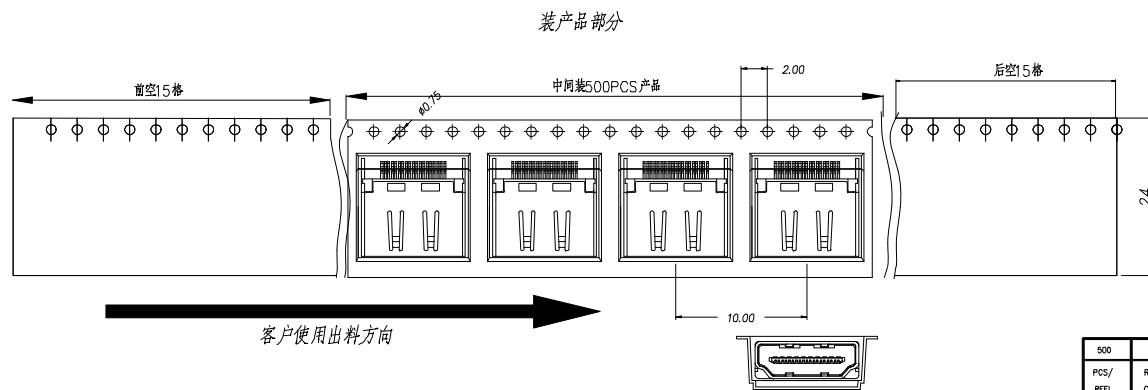
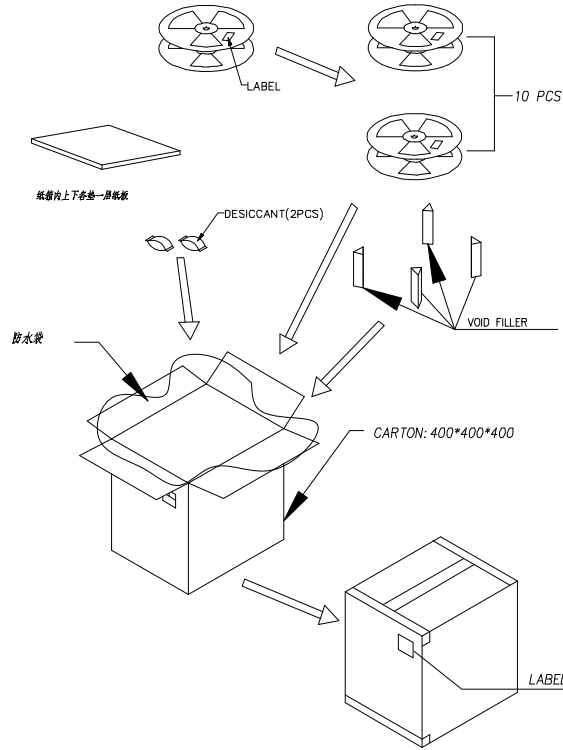
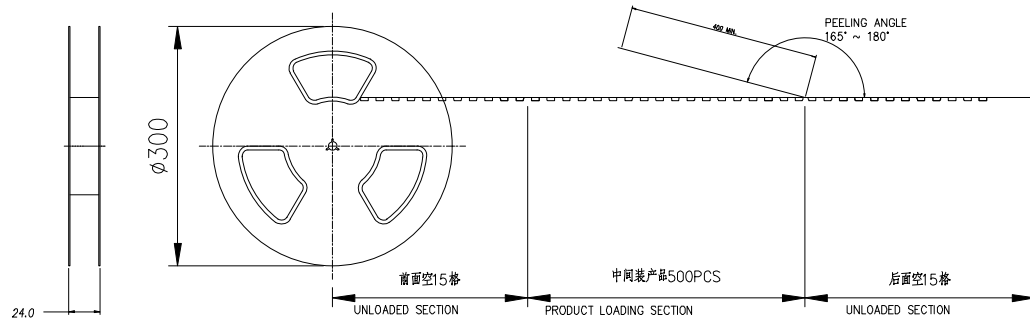

PCS/REEL	REELS/CARTON	QUANTITY	GROSS WEIGHT	NET WEIGHT	SINGLE WEIGHT
500	10	500 PCS	---KG	---KG	1.75g

NOTE:

- MATERIAL:
 BOX: FIBREBOARD, CORRUGATED, DOUBLE WALL.
 TAPE: POLYSTYRENES, HEAT-RESISTANT TEMPERATURE: 120°C, TRANSPARENT COLOR.
 REEL: POLYSTYRENES, HEAT-RESISTANT TEMPERATURE: 70°C, BLUE COLOR.
 BAG: POLYETHYLENE, HEAT-RESISTANT TEMPERATURE: 100°C.
- PEELING STRENGTH: 0.1 ~ 1.3 N (10 ~ 130 GRAMS)
- PEELING SPEED: 300 mm/min.

TOLERANCE UNSPECIFIED				东莞市韩晶电子有限公司 Dongguan Hanjing Electronics Co., LTD	
.0 ±0.25 .00 ±0.10 .000 ±0.10 X.* ±1.00* ASSEMBLY DRAWING		TITLE: HDMI 夹板式每座 包装图			
DRAWN DATE	Rain.Yi 2023/04/13	SIZE: A4	UNIT: mm.	PART.NO:	HAR01-1194K-00BR
CHECKED DATE	Rain.Yi 2023/04/13	SCALE: 1:1	PROJECTION		REV.: A
APPROVED DATE	LCY 2023/04/13	DWG PATH			PATH 2/2